

A-25-26

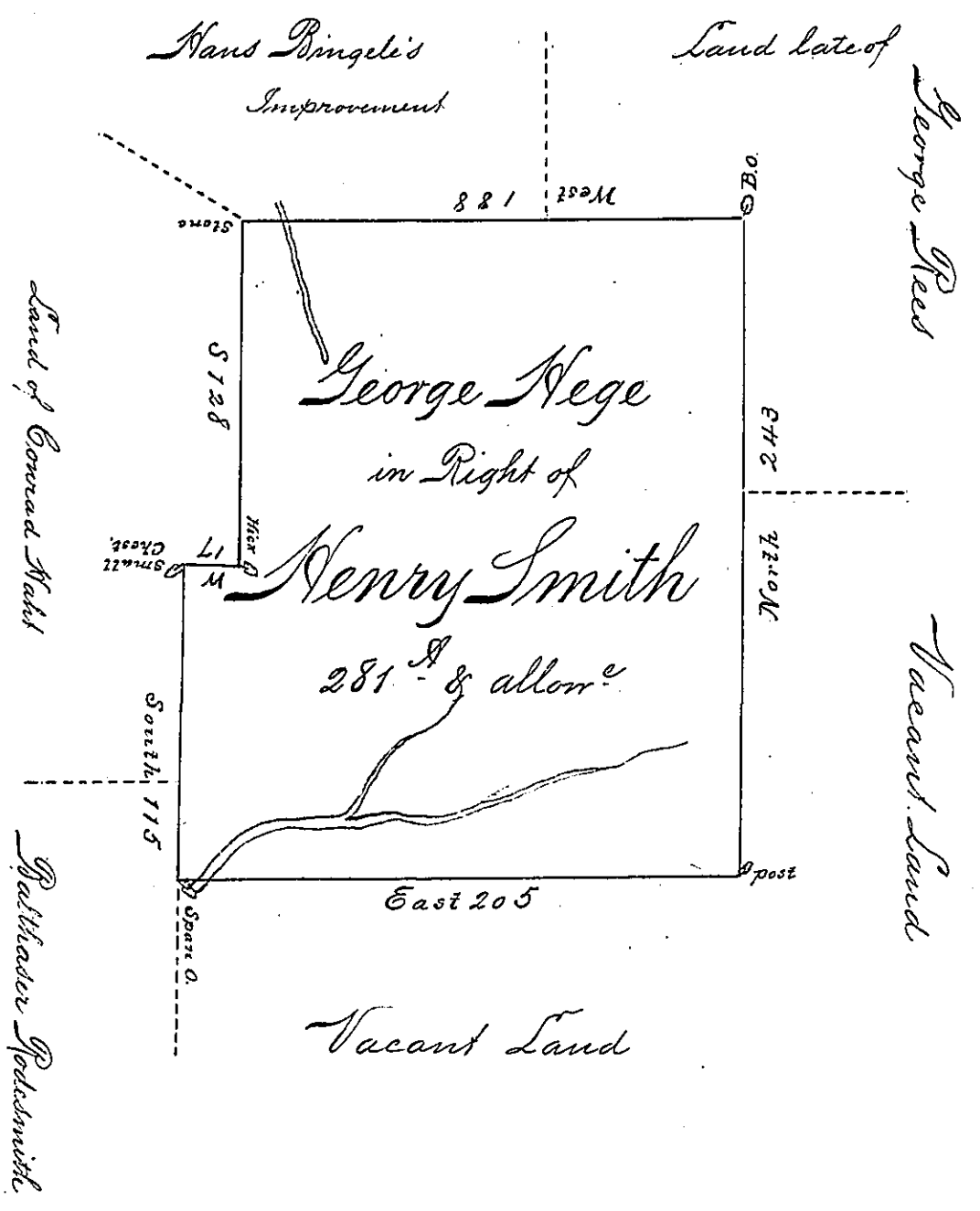

The Draught of a Tract of Land Surveyed to
 George Nege ²⁸¹ Right of Henry Smith By
 Warrant Dated the 11th Day of the ²² called
 January 1737 Situate on Muddy Creek
 formerly in Lau ²² County now in Curry
 Township in Berks County
 Surveyed the 21st Day of the Mo } p Sam^l Lightfoot
 called September 1748

IN TESTIMONY that the above is a copy of the original remaining on file in the
 Department of Internal Affairs of Pennsylvania, made con-
 formably to an Act of Assembly approved the 16th day of
 February, 1833, I have hereunto set my Hand and caused
 the Seal of said Department to be affixed at Harrisburg, this

Seventh day of January 1896

James W. Latta
 Secretary of Internal Affairs.

243
 25